

midmorning two lane causeway double yellow line seemingly endless stretching south guard rail running windows
down ocean air inhale cool **Get behind the wheel** breezy coral rocks showing brown pock-
marked lily pads **of your dreams** coral rock rock rock shoreline dot dot dot sunny clear light powder

blue sky airplane contrail puffy white clouds scattered about floating slowly water reflecting shiny light meeting
horizon water brilliant crystal clear shades of light green dark green shallow turquoise light blue deep dark blue
patches pelican diving submerged reappearing catching fish flipping gulping distant buoys flashing light causeway

ends fisherman casting over railing city limits entering fresh seafood shop seaside store souvenirs galore! coffee shop
try our key lime pie covered road turning nature preserve dunes waving tall grassy patches empty beaches crushed
seashells bright white gently tumbling beach the shore sea gulls

scurrying edge kids
take of dials hat
folding book

Hemisphere
book
warning
walking waters edged

legs leaving town beach highway edge of key pier dock dock marina house boat sail boat sail
boat catamaran shiny white slowing flashing yellow lights stopping draw bridge raising large sail boat masthead

visible moving slowly under bridge lowering bridge crossing fisherman fisherman fisherman lines dangling looking
up sea plane shadow chasing speed boat racing passing bikers parked on roadside waving marshy inlet palmetto



"the motorhome people"



Pursuit 2005



Motorhomes for the modern-day Lewis and Clark

Trust us. We know the feeling. In fact, we're almost certain the impulse resides somewhere deep within your genetic code. It's your insatiable appetite to explore. To visit the places you've only read about or perhaps seen on the Travel Channel. We think *you* know the feeling—the more curious, restless side to your personality that can't sit still.

At GBM, we've been in the recreational vehicle business since 1968. Our goal is to design and build motorhomes that can keep up with the explorer in you. This means working hard to ensure that every detail of your new Georgie Boy is right—before you turn the key. Of course, our commitment to quality also means a few late-night trips to the coffeemaker. But then again, that's why we call ourselves the motorhome people. It's also why a Georgie Boy is born to run—with your imagination.

Presenting the new 2005 Pursuit line from GBM—"the motorhome people."[®]

It's more than an RV. It's a Pursuit.[®]

It's the chance for you to make family history, turning your annual vacation into an adventure they'll never forget. It's about staying that extra day and not having to change hotel or flight reservations to do it.

In a Pursuit, you'll do more, see more and experience more—all for less money than any other motorhome in its class. Your 2005 Pursuit is loaded with new features inside and out, making it one of the best all-around values on the road.

Perhaps best of all, the Pursuit will help you make the most of a precious commodity—one that's getting tougher for most families to find—free time. Let a Pursuit inspire you.

New exterior graphics come complete with an optional painted skirt for those second (and third) looks on the highway. This year, Pursuit features a standard graphic package or an optional color pallet—Canyon Metallic.

Finding room for the souvenirs is no problem. Pursuit provides you with ample, well-lit exterior storage compartments with new slide-out-friendly baggage doors. Also new for 2005—upgraded exterior mirrors that reduce blind spots for increased visibility and quick and easy scanning.

A new push-button Big Foot manual leveling system makes quick work of finding the perfect place to park.

For those late sunny afternoons, you'll appreciate the shade of the large awning. And, tinted windows not only help keep the heat at bay, but also protect your fabrics.



Rick Browne, cookbook author and host of public television's "Barbecue America," travels the country's highways, back roads and bayous in his Georgie Boy motorhome on a savory quest for "true Q."



The keys to making good time and having one.

Remember your first big family road trip? It's a safe bet that there were a few things you wish you could have taken along. To understand why a Pursuit delivers the most value—the most motorhome for your money, just take a peek inside. The Pursuit is loaded with creature comforts. Just expect to make a few trips to the video store! With a Samsung® 27" flat-screen, overhead TV, your Pursuit is a mobile movie theater. New Flexsteel® furniture, available in a variety of new fabrics (Saffron Willow shown here), makes every seat the most comfortable seat in the house. This includes your driver and passenger seats, which swivel 360° to become part of your living area. Once in your new Pursuit, get ready to hear a new expression: "Are we there *already?*"



Dinette

Our family dinette measures a full six feet wide, larger than many of our competitors'. But space isn't the only benefit—your guests can also ride safely in the dinette. It's equipped with four seatbelts, so your guests can eat a snack or play games while riding.

A slide-out in the living area creates ample space for entertaining when parked. Because of the slide-out depth, we were able to include front and rear windows for additional ventilation.



Bedroom

Your Pursuit master bedroom is spacious and private, featuring a queen-size bed, large wardrobe and beautiful Welbeck Birch cabinetry throughout. Make this room your personal retreat. The 3180 DS model, shown here, features a lounge area with a swivel chair and an optional 20" TV, perfect for relaxing.



Kitchen

Imagine taking your home kitchen on the road with you. New for 2005, we installed larger drawers and plenty of cabinet space, so you can store all your kitchenware and food necessities. Every appliance, including the microwave oven, is right where it should be.



Bathroom

Take pleasure in the natural lighting of the Pursuit bath with a skylight over the large shower. Ample storage space is available, so you can enjoy the luxuries of home—on the road!



Pursuit® Features

Exterior

Standard

Radial Spare Tire
Big Foot Leveling Jacks
Trunk Lights
Patio Light by Entry Door
Mud Flaps—Front & Rear
Double Electric Step at Entry Door
Auxiliary Battery System Dual Deep Cycle
Battery System Emergency Start
Single Water Fill w/Change-Over Valve
Exterior Shower w/ Hot & Cold (Sewer Comp.)
Heated/Enclosed Holding Tank Comp.
Battery Disconnect
Electric Supply Cord 30 Amp.
60 Amp. Converter
Awning Rails w/ Gutter
Slide Room Awning
Side Mount Exterior Mirrors—Heated & Remote
Delay Wiper Switch
20' Sewer Hose
Black Tank Rinse System
Automotive Underbody Undercoating
Pneumatic Water Line Winterizing Fitting
Gas Struts—Exterior Compartment Doors

Optional

Canyon Metallic Exterior Paint
Driving Lights
Stainless Steel Simulators
Trailer Hitch
Electric Supply Cord 50 Amp.
Rear Ladder
Main Awning
Thermopane Windows
Locking Gas Fill Door
Driver Door & Slider Window
Transit Front Cap Cover

Interior

Standard

Welbeck Birch Cabinetry
Linoleum Floor—Kitchen & Bath
Doors in Dinette Base
Booth Dinette
Hardwood Cabinet Doors
Monitor System
Skylight in Bath
Handrail at Entry Door
Mini Blinds—Living Room & Bedroom
Standard Mattress
Bedsread
Plastic Sink Cover

Optional

Freestanding Dinette w/ 2 Freestanding &
2 Extra Folding Chairs (2970 DS & 3500 DS)
Polar Aire Fan w/ Thermostat & Rain Sensor
Day/Night Shades—Living Room & Bedroom
Day/Night Shades—Living Room Only
Upgrade Mattress
Range Cover—Bifold

Comfort & Convenience

Standard

Marine Type Toilet
Bath Light Switch
Power Bath Vent
Shower Door

Driver's Accessories

Standard

Swivel/Reclining Driver & Passenger Seats
Windshield Privacy Drapes on Track
Daytime Running Lights
ABS Drink Tray
12V Power Outlet at Dash

Optional

Defroster Assist Fans w/ Dash Switch

Appliances

Standard

Pre-Wire for Roof A/C
Generator Ready
Ducted Roof
31,000 BTU Furnace (2970 DS, 3180 DS);
(2) 25,000 BTU Furnaces (3500 DS)
3-Burner Cooktop
1.0 Cu. Ft. Microwave Built In
Double-Door Refrigerator
Water Heater Bypass
Water Heater (6 Gal.) w/ Electric Ignition

Optional

4,000 Watt Onan® Micro-Quiet & 13,500 BTU
Roof A/C (2970 DS, 3180 DS)
4,000 Watt Onan® Micro-Quiet & 15,000 BTU
Roof A/C (2970 DS, 3180 DS)
5,500 Watt Onan® Marquis Gold & 13,500 &
11,000 BTU Roof A/C
7,000 Watt Onan® Marquis Gold &
(2) 13,500 BTU Roof A/Cs
Heat Strip w/ Roof A/C
Low-Profile Roof A/C
3-Burner Range w/ Oven (17")
1.0 Cu. Ft. Half Time® Microwave Built In
Large Double-Door Refrigerator
Water Filter System
Gas/Electric Water Heater

Audio/Visual

Standard

4 Radio Speakers
AM/FM Stereo CD
Front TV 27"—Living Room
TV Antenna w/ Booster
Cable TV & Phone Jacks
Rear Camera Cable

Optional

CB Antenna (Only)
20" TV—Bedroom (120 V)
VCR/DVD Combo
TV Distribution Panel
Remote Rear Camera w/ Monitor

Fabrics

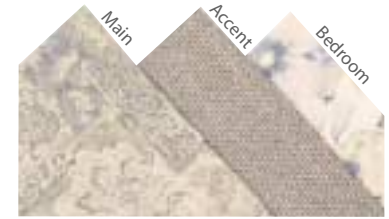

Baywater Blue



Saffron Willow



Chestnut Falls

Wood



Welbeck Birch

Exterior Graphics



Standard



Optional Canyon Metallic Paint
(Front view featured on cover)

Sidewall Construction

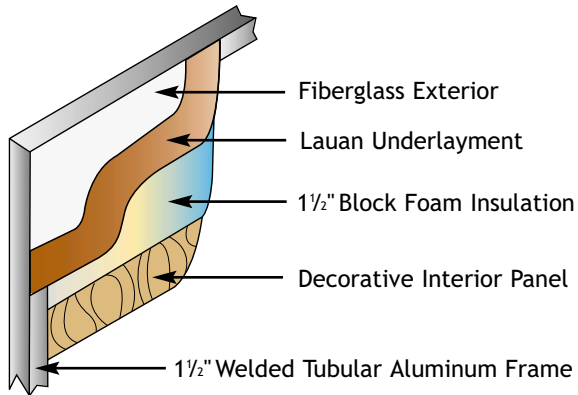

Floor Plan Options

2970 DS

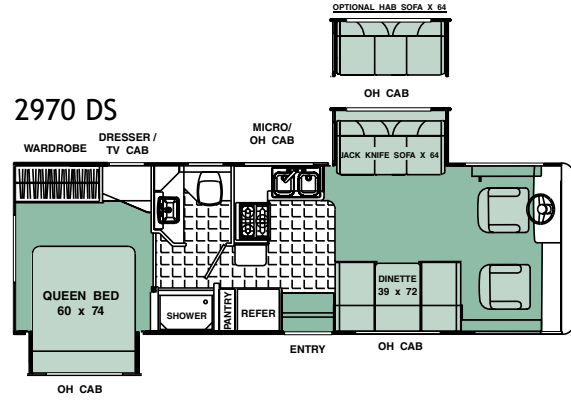

3180 DS

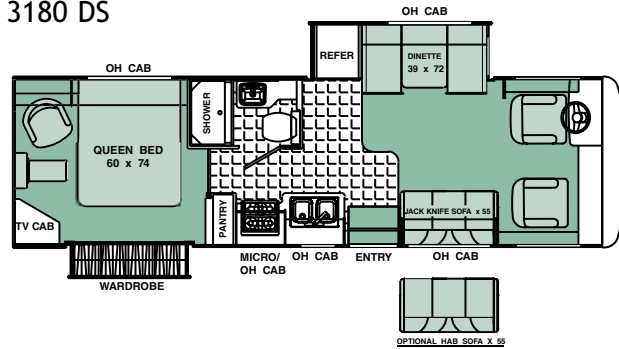

3500 DS

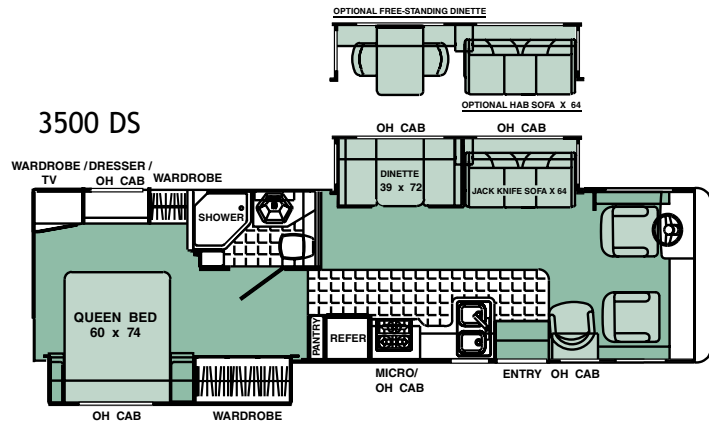



"the motorhome people"

Specifications

	2970 DS	3180 DS	3500 DS
Chassis	Ford	Ford	Ford
Chassis Model	F-53	F-53	F-53
Engine Size (liter)	6.8	6.8	6.8
Wheel Base	190"	208"	228"
Tire Size	225/70R 19.5	225/70R 19.5	245/70R 19.5
GVWR (lbs.)	18,000	18,000	20,500
UVW (lbs.)	15,000	15,800	16,800
GAWR Front (lbs.)	7,000	7,000	7,500
GAWR Rear (lbs.)	11,000	11,000	13,500
GCWR (lbs.)	26,000	26,000	26,000
Exterior Length	29' 9"	31' 5"	34' 9"
Exterior Clearance Height*	11' 9"	11' 9"	11' 9"
Exterior Width	8' 4"	8' 4"	8' 4"
Interior Width	7' 11 1/4"	7' 11 1/4"	7' 11 1/4"
Interior Height	6' 7"	6' 7"	6' 7"
Sleeping Capacity	5	5	5
Fuel Capacity (gal.)	75	75	75
Fresh Water Capacity (gal.)	58	65	75
Waste Water Capacity (gal.)	45	44	45
Grey Water Capacity (gal.)	45	45	60
Water Heater Capacity	6	6	6
LP Gas Capacity (lbs.)	65	85	100
Furnace Rating (x 1,000) BTU	31	31	(2) 25
Awning Size (ft.)	13	14	17

GVWR (Gross Vehicle Weight Rating):

The maximum permissible weight of the unit, including the UVW plus all fluids, cargo, optional equipment and accessories. For safety and product performance, do not exceed GVWR.

UVW (Unloaded Vehicle Weight):

Means the weight of a motorhome as manufactured at the factory with fuel, engine oil and coolants. The above UVWs represent a motorhome with typical options. UVW will vary significantly based on option selection.

GAWR (Gross Axle Weight Rating):

The total weight each front/rear axle, suspension and tire system is designed to carry. When loading the unit, care should be taken to balance cargo weight in consideration of the GAWRs.

GCWR (Gross Combined Weight Rating):

The maximum total weight of the loaded unit plus a tow vehicle. This includes the weight of both the unit and tow vehicle, fuel for each, all other fluids, cargo, occupants, optional equipment and accessories.

* Includes clearance for air conditioner and satellite dish.

IMPORTANT NOTE: All capacities are approximate and all dimensions are nominal. Georgie Boy motorhomes are designed to allow for a wide variety of uses, extended trips with two people or short trips with multiple people. Accordingly, each unit allows ample room for sleeping, seating, fluids and cargo. While the customer is the beneficiary of this design, the customer also bears the responsibility to select the proper combination of passengers, cargo, load and tow vehicle without exceeding the chassis weight capabilities. Consumers may need additional braking capacity to tow loads greater than 1,000 pounds. Seat belts should always be worn for passenger safety. Seat belts are provided at most locations to allow convenience in selecting which seat to occupy. However, it is not intended that all seating positions equipped with a seat belt may be occupied while the vehicle is in motion, without regard to other weight factors. All Georgie Boy motorhomes are designed to ensure that the number of passengers allowed while the vehicle is in motion will always at least equal the stated sleeping capacity. Though extra seat belts may be provided, for your safety and the proper operation of your vehicle, limit your passengers to the number allowed by the Net Carrying Capacity of your vehicle.

We hope that you find this comprehensive, factual catalog helpful. All information contained in this brochure is believed to be accurate at the time of publication. However, during the model year, it may be necessary to make revisions and Georgie Boy reserves the right to make all such changes without notice, including changes in prices, colors, materials, equipment and specifications, as well as the addition of new models and the discontinuance of models shown in this brochure. Also, some equipment shown or described is optional and available at extra cost. Therefore, please consult with your Georgie Boy dealer to confirm the existence of any materials, design or specifications that are material to your purchase decision.

Georgie Boy Mfg., LLC • 69950 M62 • Edwardsburg, MI 49112 • Phone (269) 663-3415
Fax (269) 663-2065 • Sales (877) 876-9024 • Service (800) 521-8733
Web Site: www.georgieboy.com • Owners Club: www.georgieboyrvclub.com

Your Dealer:

Pursuit 2005